

The Dungeness River Audubon Center at Railroad Bridge Park in Sequim, Washington, has provided an oasis for people to connect with nature. Our science-based programs, field trips, and bird walks inspire wonder and increase understanding of the unique natural environment of the park and beyond. We provide access to world class birding, low-bank access to the Dungeness River, cultural connections to historic resources and local Tribes at our 70-acre park.

Successes in 2017 ...

- Served 22,938 visitors
- Organized 616 educational programs, exhibits, field trips, meetings, and events
- Engaged 4,170 children in hands-on science
- Conducted weekly bird walks for 920 participants
- Recorded 150,000 Dungeness River crossings on historic railroad bridge



Today ...

More than ever before people need connections to nature. Local residents and visitors pack our classes, field trips, and summer camps. The one-room building is frequently used for classes and meetings while Center visitors are trying to view the exhibits. This results in an uncomfortable and challenging learning environment for everyone. The parking lot is overflowing with cars and the access road periodically floods. We are at capacity and turning people away. We've simply outgrown our small Center.

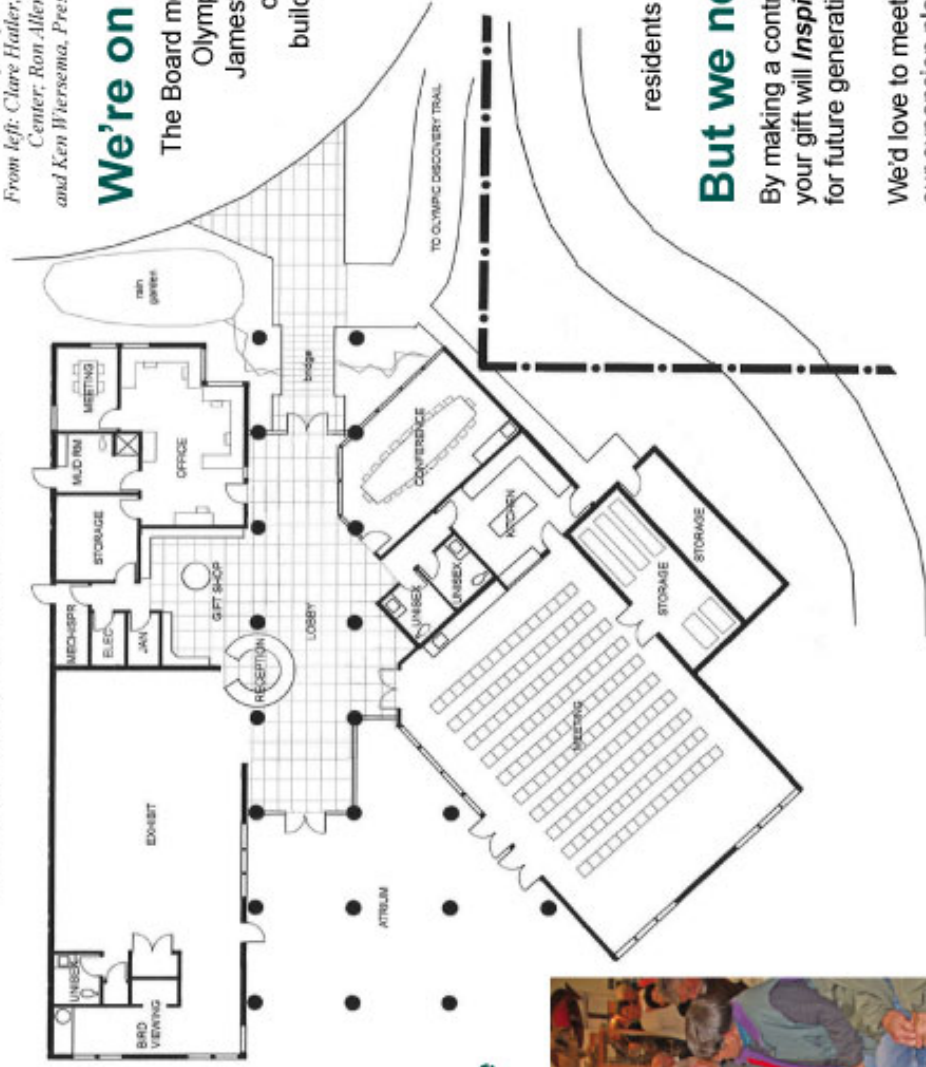

Proposed Building Expansion and Remodel



2017 Signing Ceremony for the expansion of the Center. From left: Clare Hadler, Vice-President of the Dungeness River Audubon Center; Ron Allen, Chair of the Jamestown S'Klallam Tribe, and Ken Wiersema, President of the Olympic Peninsula Audubon Society.

We're on our way ...

The Board members of the Center and partners, Olympic Peninsula Audubon Society and Jamestown S'Klallam Tribal Council, have committed to expanding the existing building. The expansion and renovation will add 5,500 square feet of education, office, and meeting space and increase parking spaces and improve access to the Center and Trail.

The partners strongly believe that this expansion is critically necessary and will significantly increase opportunities for local residents and visitors to connect with nature.

But we need your help ...

By making a contribution to the building campaign, your gift will *Inspire Wonder*, providing opportunities for future generations to connect with nature.

We'd love to meet with you or your group to discuss our expansion plans and how you can help. You may give online at www.dungenessrivercenter.org.